

Roller Hangers »

Roller hangers are designed for use with a catenary cable for supporting electric, air, hydraulic and other flexible lines and/or cables to fixed and moveable equipment.

Features



- » Simple installation of cables/hoses to a catenary wire
- » Keeps cables/hose safely off the ground
- » Rugged, abrasion and oil proof resin moulding
- » Corrosion resistant metal hardware
- » Light weight, high strength polycarbonate thermoplastic material
- » Self locking adjustable swivel clamp for round hose or cable
- » Requires no lubrication
- » No tools required for installation

Applications

- » Extension leads
- » Electric cable
- » Airline hose
- » Hydraulic hose

Selection Data

Cat. No.	Catenary Wire Dia	Cable Hose Dia	Roller to Cable/Hose Centres	Roller Hanger Width	Pack Qty
SRH1	3 - 8mm	11 - 18mm	76mm	32mm	1
SRH2	3 - 10mm	19 - 29mm	88mm	37mm	1

Installation

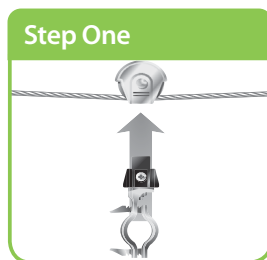

Press the roller holder with two fingers, bend the bracket and roller holder should release.



Put the roller hanger on a catenary line and push the bracket upward to couple together.

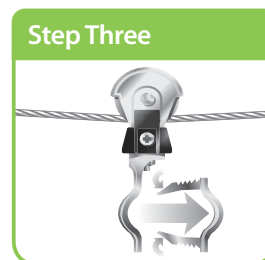

Hold and press both clamping prongs to release from the clamp holder.



Hold cable/hose on the clamp holder and push the clamping prongs into the clamp holder (lower clamp prong then push upper prong).